

PHASE 3

TRAFFIC CONFIGURATION



WB Crossover 1: Kentucky

- ▶ Signage will be in place to direct motorists
- ▶ Motorists driving westbound and planning to access New Albany via Exit 123 will need to be in the right lane (upper deck)
- ▶ Access to I-264 from center lane ONLY
- ▶ I-64 westbound through traffic can use either left or right lane
- ▶ No access to New Albany (Exit 123) from left lane

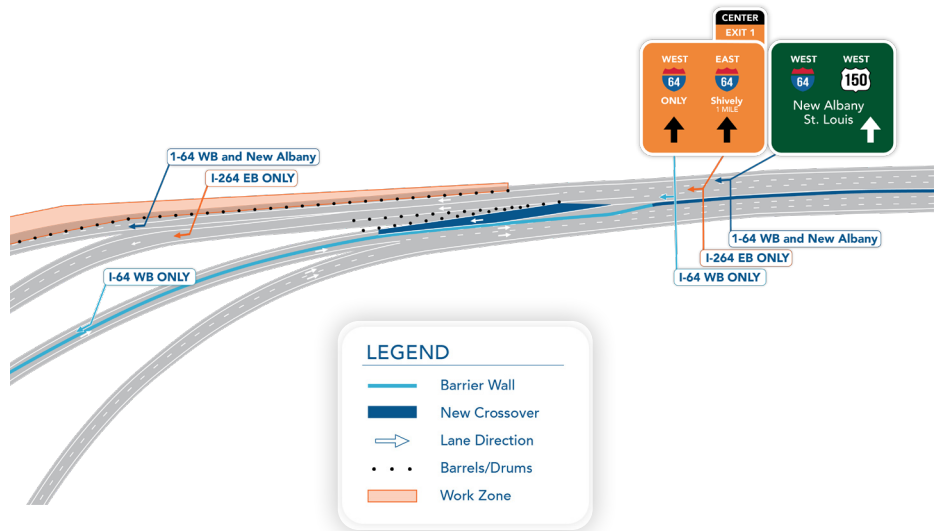

Crossover I-264

- ▶ I-64 westbound from lower deck will not have access to New Albany (Exit 123)
- ▶ I-264 westbound will not have access to New Albany (Exit 123)
- ▶ Continuing eastbound I-64 traffic left lane only
- ▶ Eastbound I-64 to I-264 east right lane only

WB Crossover 2: Indiana

- ▶ Eastbound I-64 travel will be reduced to two lanes
- ▶ Westbound I-64 access to New Albany (Exit 123) from upper deck only
- ▶ No access to New Albany from I-264 westbound

